

# HOW TO INSTALL YOUR LARES SAVER & CERAMIC SILENT FORCE SAVER TURBINE CARTRIDGE... STEP BY STEP.

If replacements cannot be made successfully, please return the entire handpiece to Lares Research for factory repair.

Should you need information about the operation, maintenance, or service of your Lares product contact us directly. Lares Research is here to help you.

**Within the U.S.A. 1-888-333-8440**

**Worldwide 530-345-1767**

Outside the USA contact your Authorized Lares Distributor.

## Procedure

1. Wear exam gloves.
2. Secure an expended standard length bur in chuck.
3. Mark head cap and handpiece with a permanent marker before opening. This is critical to assure head cap is tightened properly when replacement turbine is installed (**Figure 1**).
4. Engage cap wrench in slots on head cap (**Figure 2**). Grasp cap wrench firmly. Turn counterclockwise with inward pressure until threads are disengaged (**Figure 3**). **Note: The same force required to loosen cap should be used when tightening cap during reassembly.**
5. Making sure the cap is fully disengaged, press bur down against flat surface to remove old cartridge and cap from head (**Figure 4**). Remove head cap assembly from turbine cartridge. Discard worn turbine cartridge and retain head cap. For Ceramic Saver, locate and retain both wave springs, one between the cap and turbine bearing and the other one between the head bore and turbine bearing (below o-rings). (**Figure 10**).

**Note: If ball bearing is destroyed we recommend that the outer ring of the ball bearing, which remained in the turbine housing or in the cap, is removed by an authorized Lares repair facility by means of a special tool.**

6. Flush interior of head and head cap assembly with alcohol and clean with cotton swab. Flush again and inspect for cleanliness. Repeat if necessary.

**Note:** Please do not open the new turbine pouch until the handpiece has been prepared as above. This will assure maximum life and performance from the turbine. The pouch and turbine have been manufactured and sealed within a clean zone, which protects the precision bearings from possible contamination.

7. Apply Lares conditioner to the entire area of the head and head cap interior. For CeramicSaver, verify position of wave springs (**Figure 10**), one in head cap and one in head bore (beyond o-rings). Remove the new turbine from the pouch.

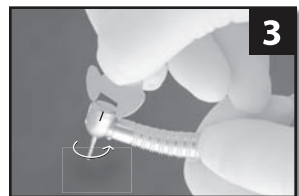
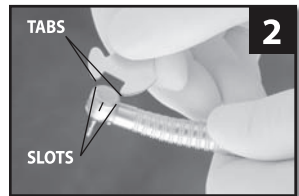
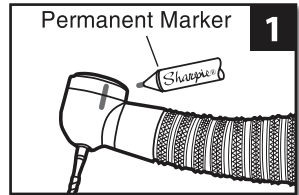

## Procedure Continued:

8. Insert into head cap assembly until fully seated. Then carefully insert entire assembly (bur end first) into turbine head (**Figure 5**) until cap rests against back of turbine head. Turn counterclockwise with light pressure until seated as indicated by "click" sound (**Figure 6**). Then turn clockwise with light inward pressure until fully engaged in head.
9. Insert cap wrench into slots in cap (**Figure 7**), and with inward pressure, turn head cap wrench clockwise until fully tightened (**Figure 8**). Use same force to tighten as was used to loosen it. Tighten the head cap with the wrench until it is tight and the marked lines meet.
10. **Double check** to make sure that the head cap is fully tightened so that the mark on the head cap and head line up (**Figure 8**).



**WARNING:** If cap is tightened improperly (too loose) it may result in the turbine ejecting itself during use.

11. Lubricate handpiece using a well shaken can of Lares One-Step Conditioner with lube nozzle. Apply conditioner to handpiece for 2 seconds over a sink or towel (**Figure 9**) With a bur in place run handpiece without water for 45 seconds to expel excess conditioner. Wipe off excess conditioner with a towel.

Your handpiece is now ready to operate.

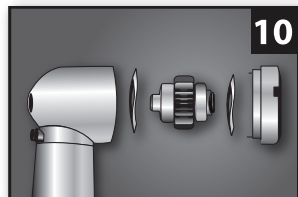
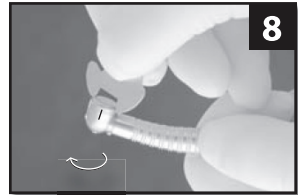
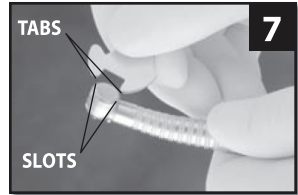

## LIMITED WARRANTY

Lares replacement turbine cartridges with push button bur changing are warranted against defects in materials and workmanship for a period of 6 months from date of shipment.

1. Warranty registration is automatic through our computer as of shipping date, and warranty registration cards are no longer necessary for U.S.A. customers. Outside of the U.S.A. a warranty card may be required by your distributor.
2. The handpiece must be operated and maintained in accordance with procedures outlined in the instructions.
3. The handpiece must not be subjected to abuse or neglect.
4. The handpiece must not have been repaired or disassembled by anyone other than Lares Research or your Authorized Lares Distributor.

*Lares Research, Inc. will repair or replace, at its discretion, without charge any defective parts covered by this warranty provided the handpiece is returned to the factory, accompanied by a completed service information card. (Outside the U.S.A. return to your Authorized Lares Distributor). Lares Research makes no other warranties, expressed or implied.*

### Replacement Parts:

10035 Nozzle 4/5H Non-Swivel	12005-022 557 Model Saver Turbine	10083 One-Step Conditioner
10033 Nozzle Lares Swivel	12016-022 757 Model Saver Turbine	12005-036 557 Model Saver Turbine
10085 Nozzle MX Swivel	12071-022 757 Tri-Port Saver Turbine	12071-036 757 Model Saver Turbine

**lares**<sup>®</sup>  
RESEARCH

Your cutting edge

295 Lockheed Avenue  
Chico, CA 95973 U.S.A  
530-345-1767 • Fax 530-345-1870  
[www.laresdental.com](http://www.laresdental.com)